

- 722 guest rooms including Kings and King/King rooms, plus up to 40 suites
- 60,000 square feet of meeting space including an 18,000 square foot ballroom
- 900 covered parking spaces
- Fitness center, themed restaurant and lounge, business center, concierge
- Owned and operated by The Davenport Hotel Collection

ACCOMMODATIONS

The new Spokane Convention Center Hotel guest rooms will be configured with one or two king beds (verses the industry standard of double/double or queen/queen configuration).

All guest rooms will offer the following amenities

- Luxurious "Davenport beds"
- Frette fine linens
- L'Occitane luxurious bath products
- 32-inch LCD High Definition televisions with Lodge Net movies and music
- Large marble walk-in showers
- Individual temperature control
- Daylight and privacy curtains
- Three telephones with voice mail and private direct-line capability
- In-room safe, iron and ironing board, make-up mirror and hair dryer
- Custom made furniture
- Work desk with direct illumination

Guests will enjoy the following complimentary services

- Local telephone calls
- Wired and wireless Internet in guest room and lobby
- Luggage storage
- 24-hour Business Center
- Full-service Concierge
- Daily turndown service
- 24-hour Fitness Center with complimentary towels
- Shoeshine
- Town Car service within a two mile radius of the hotel
- Daily newspapers
- In-room Safes

At additional cost

- Room Service
- One-hour laundry pressing
- Town Car service (airport)
- Group shuttle van service (airport)
- Valet parking and Self-parking
- Dog friendly (\$30 nightly fee)

GUEST ROOMS and SUITES

All guest rooms are non-smoking and range in size from 452 sq.ft. to 3,000 sq.ft.

DINING

The Hotel restaurant and lounge plus lobby espresso bar will have something for everyone.

ACCESS TO CONVENTION CENTER

The Spokane Convention Center, INB Performing Arts Center are connected to the Hotel via a skywalk. The Spokane Veteran's Arena, River Front Park and Spokane River are all within walking distance.

AIRPORT TRANSPORTATION

The Hotel is located 7 miles (approximately 15 – 20 minutes) from the Spokane International Airport. The Hotel will provide Town Car service between the hours of 5:00 am and midnight, or by appointment, daily. This service will be available to all registered guests, based on availability. Requests within a 2-mile radius are complimentary for registered guests.

A GREAT LOCATION, A VIBRANT TOWN, A BEAUTIFUL REGION

Downtown Spokane is a vibrant, vital place, with shops, theaters, art galleries, spas, restaurants and outdoor activities all within easy reach of the Hotel. Nearby shopping options include River Park Square Urban Mall, Nordstrom and Apple.

Spokane's renowned Riverfront Park is just across the street. White water rafting excursions are within walking distance to the Hotel. The Centennial bike trail, and great golf courses are close by, and Silverwood Theme Park is 30 miles east of the city. Beautiful Coeur d'Alene, Idaho is just 35 miles away.

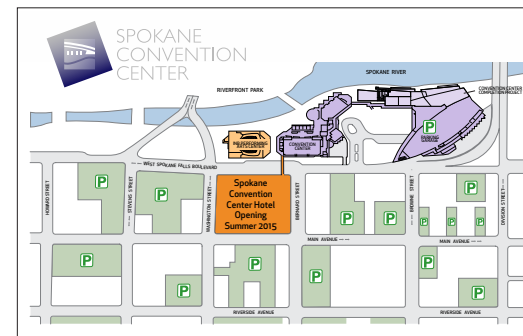

CONTACT
Meg Harper, Director of Sales
Direct: 509 789 6811
Email: mharper@thedavenportotel.com
davenportotelcollection.com

The Davenport Hotel Collection • 10 South Post Street, Spokane, WA 99201

SPOKANE CONVENTION CENTER HOTEL



Floorplan and Data Sheet
 Opening Summer 2015

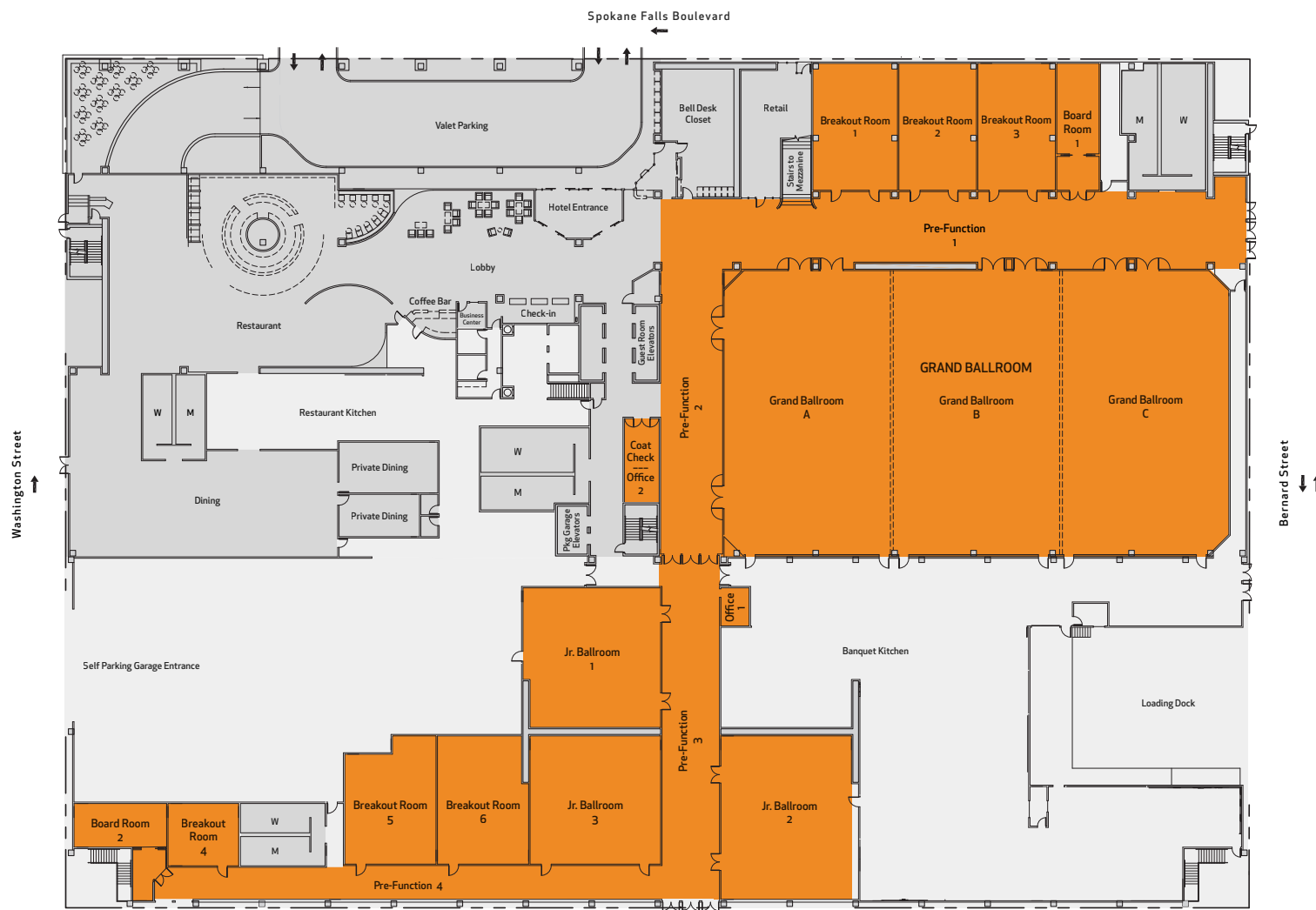

Main Floor

Meeting Room Space
 Public Areas
 Back of the House Areas

MEETING SPACE	SQUARE FEET	DIMENSIONS	THEATER	CLASSROOM	ROUNDS OF 10	CONFERENCE	U-SHAPE	HOLLOW SQUARE	RECEPTION	10 X 10s	8 X 8s
MAIN FLOOR											
Grand Ballroom	18,079	101' x 179'	1,600	1,150	1,200	•	•	•	1800	82	124
Grand Ballroom A	5,959	101' x 59'	432	384	410	•	•	•	600	29	38
Grand Ballroom B	5,959	101' x 59'	432	384	410	•	•	•	600	31	42
Grand Ballroom C	5,959	101' x 59'	432	384	410	•	•	•	600	31	42
Jr. Ballroom 1	2,401	49' x 49'	240	112	160	40	48	64	250	8	16
Jr. Ballroom 2	2,668	58' x 46'	280	128	200	48	56	72	280	11	19
Jr. Ballroom 3	2,116	46' x 46'	216	112	140	32	48	64	200	8	16
Breakout Room 1	1,350	45' x 30'	124	76	80	32	36	40	150	•	•
Breakout Room 2	1,260	45' x 28'	110	52	70	32	36	40	120	•	•
Breakout Room 3	1,260	45' x 28'	110	52	70	32	36	40	120	•	•
Breakout Room 4	550	22' x 25'	52	24	30	16	20	16	50	•	•
Breakout Room 5	1,248	39' x 32'	136	72	70	32	36	40	120	•	•
Breakout Room 6	1,440	45' x 32'	144	84	80	32	40	48	140	•	•
Boardroom 1	480	32' x 15'	•	•	•	24	•	•	•	•	•
Boardroom 2	495	15' x 33'	•	•	•	24	•	•	•	•	•
Office 1	130	13' x 10'	•	•	•	•	•	•	•	•	•
Coat Check / Office 2	360	30' x 12'	•	•	•	•	•	•	•	•	•
Pre-function 1	4,833	27' x 179'	•	•	•	•	•	•	•	7	13
Pre-function 2	2,222	101' x 22'	•	•	•	•	•	•	•	6	9
Pre-function 3	2,684	122' x 22'	•	•	•	•	•	•	•	7	17
Pre-function 4	2,100	175' x 12'	•	•	•	•	•	•	•	•	•

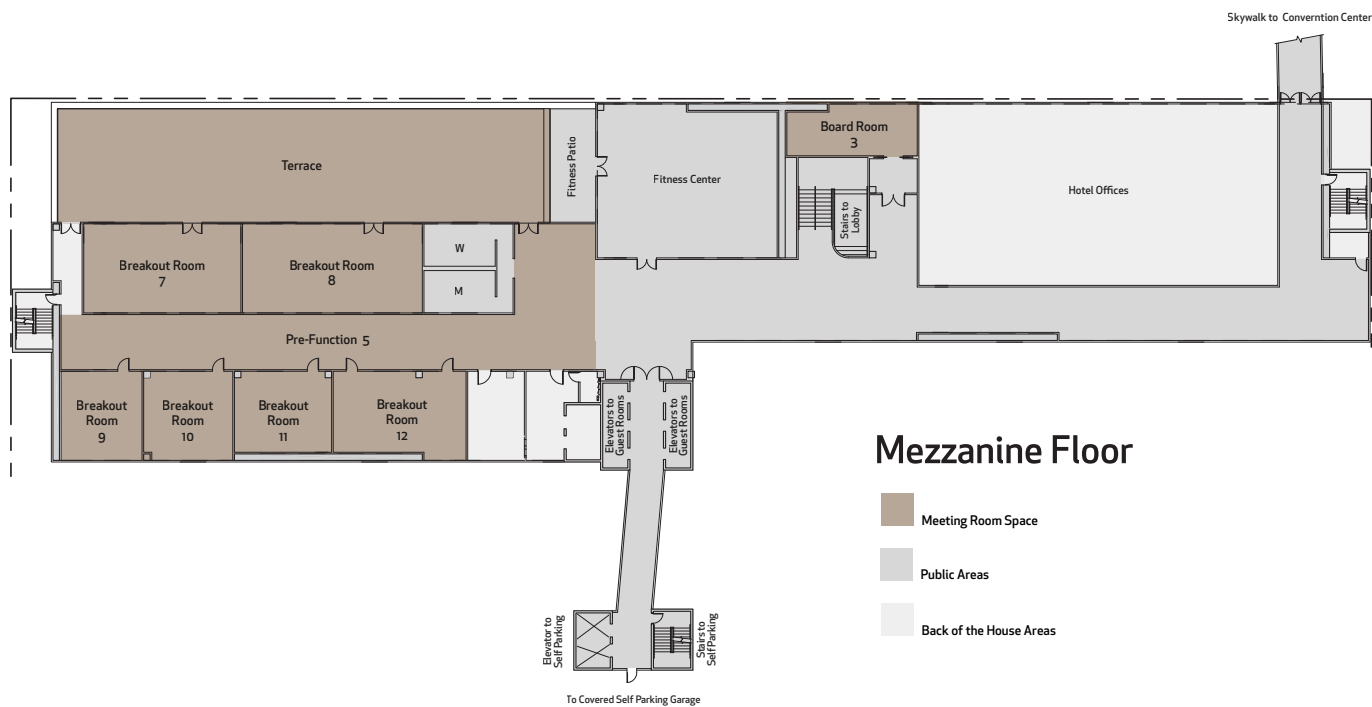

Mezzanine Floor

Meeting Room Space
 Public Areas
 Back of the House Areas

MEZZANINE FLOOR											
Breakout Room 7	1,296	27' x 48'	110	80	70	32	36	40	120	•	•
Breakout Room 8	1,485	27' x 55'	125	60	90	40	44	48	140	•	•
Breakout Room 9	675	27' x 25'	54	28	40	16	20	24	60	•	•
Breakout Room 10	783	27' x 29'	54	28	40	16	20	24	70	•	•
Breakout Room 11	725	25' x 29'	54	28	40	16	20	24	70	•	•
Breakout Room 12	1,107	27' x 41'	100	52	60	32	36	40	100	•	•
Boardroom 3	640	16' x 40'	•	•	•	32	•	•	•	•	•
Pre-function 5	2,397	17' x 141'	•	•	•	•	•	•	•	•	10
Terrace	5,250	35' x 150'	•	•	290	•	•	•	550	•	•

Total Sq. Ft. 60,034